

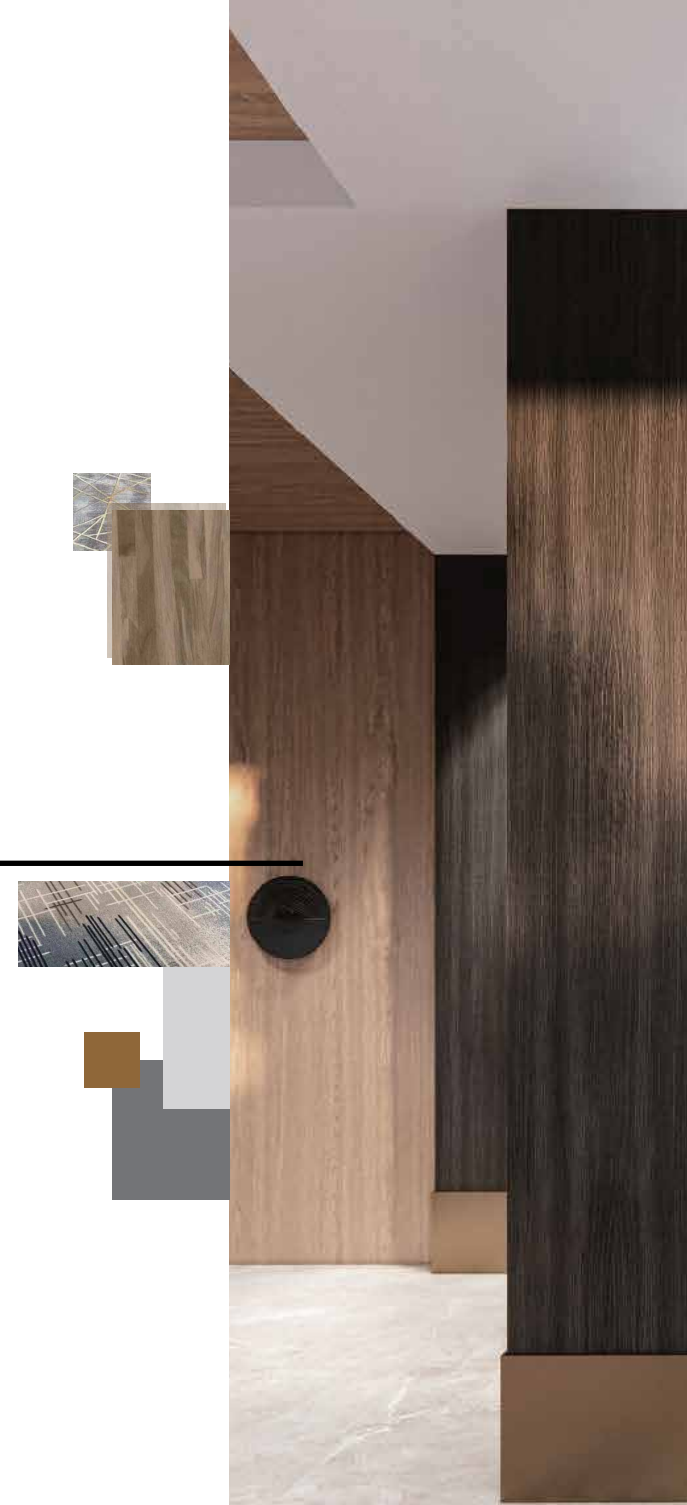

Loc 1: Antelias, Seaside, SSS Bldg, fifth floor beside AISHTI.
Loc 2: Bchamoun, Behind Louise Wegmann School, Andalos St. - SSS Bldg.
Tel: +961 71 260 007 | +961 25 803965
Email: sales@sss-lb.com
www.sss-lb.com



A PROMISE OF HAPPINESS FOR YOUR FAMILY
A PROMISE OF HAPPINESS FOR YOUR FAMILY





Preface

SSS Elevator is a comprehensive elevator manufacturing enterprise integrating R&D, manufacturing, sales, installation and after-sales service. With the three platform of R&D, intelligent manufacturing and quality inspection centers, we adhere to the company mission of "creating infinite possibilities for construction transportation".



A ARTISTIC AESTHETICS

There are thousands of interpretations of beauty
Beauty is inspired by the heart
And is reborn in a million interpretations

We understand the aesthetics of space
Explore the interaction between people and space
Unlimited aesthetic art in a limited space

Bringing aesthetics and art
In every square
In your life and travel
A comfortable experience of taking elevators
Meet technology, meet art



STANDARD OPTIONAL CABIN



U-CR223

Front wall: Hairline stainless steel
Ceiling: Square ceiling
Side walls: Mirror stainless steel + wood grain art plate.
Rear wall: Mirror stainless steel + wood grain art plate
Skirting line: Matteless black + welcome light
Floor: White marble
Recommended car door: Hairlines stainless steel



U-CR225

Front wall: Hairline stainless steel
Ceiling: Square ceiling
Side walls: Mirror stainless steel, + wood grain art plate.
Rear wall: Mirror stainless steel + wood grain art plate
Handrail: Mirror stainless steel
Floor: White marble
Recommended car door: Hairline stainless steel

STANDARD OPTIONAL CABIN



U-CR224

- Front wall: Hairline stainless steel
- Ceiling: Square ceiling
- Side walls: Mirror stainless steel + wood grain art plate
- Rear wall: Mirror stainless steel + wood grain art plate + hidden light strip
- Floor: Beige marble
- Recommended car door: Hairline stainless steel



U-CR202

- Front Wall: Hairline St. Steel
- Ceiling: Upper Powder-Coated Steel (Crescent White) + Warm Light Hidden Light Strip + Powder-Coated Steel Frame (Crescent White) + Spotlight
- Side Wall: Hairline Stainless Steel
- Rear Wall: Hairline Stainless Steel
- Flooring: Carpet
- Recommended Car Door: Hairline Stainless Steel

* The pictures on this page are for reference only.

HUMAN INTERFACE

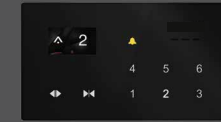

U-CF3000-A(std)



U-CF3000-B

COP (Std)
 Type: U-CF3000
 Display: 4.3 inch TFT LCD
 Button: Touch Button
 Panel: Glass

"Mechanical Push Button Optional"



U-CF3001-A



U-CF3001-B

COP
 Type: U-CF3001
 Display: 4.3 inch TFT LCD
 Button: Touch Button
 Panel: Metal frame + Glass panel

"Mechanical push button optional"



TL-200-A



TL-200-D

LOP (Std)
 Type: TL-200
 Display: LED Segment Display
 Button: Micro-Button
 Panel: Glass



TL-400N-A



TL-400N-B

LOP
 Type: TL-400N
 Display: LED Segment Display
 Button: Micro Button
 Panel: Frosted Glass Panel



U-ZW2300-A



U-ZW2300-B

LOP
 Type: U-ZW2300
 Display: 4.3 inch LED Segment Display
 Button: BR36F
 Panel: Acrylic + Stainless Steel Housing

Optional flooring:



U-FL101 (Carpet)

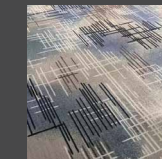

U-FL102 (Carpet)



U-FL103 (Pattern PVC)

Optional ceiling:



U-CL122 (integrated)
 Powder coated steel (Pear Silver) + Downlight



U-CL123-1 (integrated)
 Hairline St. Steel + Panel Light



U-CL300 (Split type)
 Powder coated steel frame (crescent white) + bronzed stainless steel frame + hidden light strip + Downlight

*The pictures on this page are for reference only.

MODERN STYLE



U-CR208-1

Front wall: Copper hairline stainless steel
Ceiling: Upper ceiling Powder-Coated steel plate (crescent white) + warm light hidden light strip + Powder-Coated steel plate frame (crescent white) + spotlights
Side wall: wood grain art steel plate + copper mirror stainless steel + Copper mirror stainless steel copper inlaid strip
Rear wall: bronzed sandblasted stainless steel + copper mirror stainless steel + hidden light strip
Handrail: copper hairline stainless steel (flat)
Floor: Marble
Recommended car door: copper hairline stainless steel



U-CR219-1

Front wall: Rose gold hairline stainless steel
Ceiling: Upper Powder-Coated steel plate (crescent white) + warm light hidden light strip + Powder-Coated steel frame + spotlights
Side wall: Wood film coated plate + mirror stainless steel with rose gold inlaid strip
Rear wall: laminated steel plate + mirror stainless steel with rose gold inlaid strip + rose gold mirror etching stainless steel
Floor: PVC (imitation marble)
Recommended car door: Rose gold hairline stainless steel



SIMPLE STYLE

U-CR212

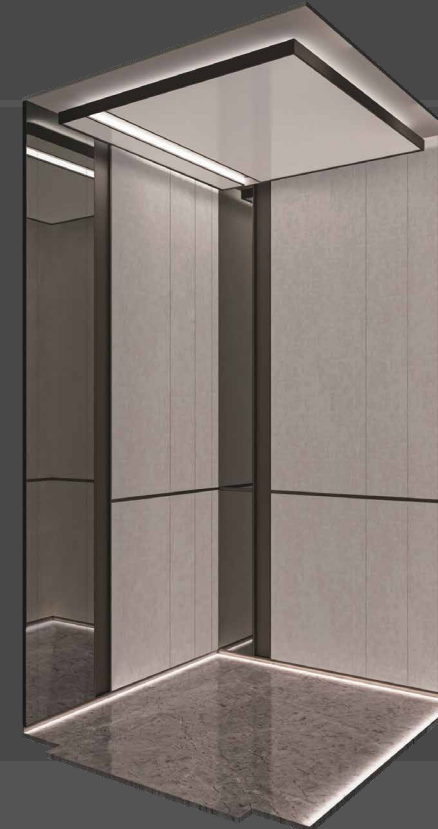

- Front wall:** Bronzed sandblasted stainless steel
- Ceiling:** Upper top sandblasted steel plate (pearl white)
+ Bronzed sandblasted stainless steel frame + mirror ceramic white veneer + hidden light strip
- Side wall:** Bronzed mirror stainless steel + Bronzed sandblasted stainless steel decorative strip + fabric decorative plate
- Rear wall:** Bronzed mirror stainless steel + bronzed sandblasted stainless steel decorative strip + fabric decorative plate
- Floor:** Marble
- Skirting line:** Bronzed sandblasted stainless steel
+ welcome light
- Recommended car door:** Bronzed sandblasted stainless steel

U-CR205



- Front wall:** Copper hairline stainless steel
- Ceiling:** Upper powder-Coated steel plate (pearl white)
+ Copper hairline stainless steel frame + imitation transparent marble printing acrylic + hidden light strip
- Side wall:** Copper hairline stainless steel inlaid strip frame + laminated art board (ceramic mirror white)
+ wood film coated panel
- Back wall:** Copper hairline stainless steel inlaid strip frame + laminated art board (ceramic mirror white)
- Floor:** Marble parquet
- Handrail:** Copper hairline stainless steel round handrail
- Recommended car door:** Copper hairline stainless steel

LUXURY STYLE



U-CR228

Front wall: Titanium black sandblasted stainless steel

Ceiling: Starry sky ceiling

Side wall: Sandblasted stainless steel + Lacquered glass (Matte black)

Rear wall: Paint glass (Matte black) + sandblasted stainless steel frame
+ paint glass (warm white) + hidden sandblasted armrest + hidden light strip

Skirting line: Sandblasted stainless steel + welcome light

Floor: Marble

Recommended car door: Titanium black sandblasted stainless steel

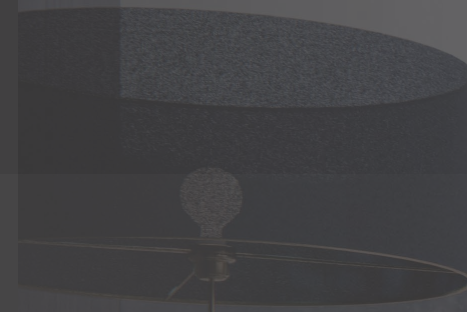

LUXURY STYLE



U-CR226

- Front wall:** bronzed hairline stainless steel
- Ceiling:** mirror stainless steel bronze plated frame + hidden light strip + downlight
- Side wall:** leather pattern hard roll + hairline stainless steel bronze inlaid strip
- Back wall:** hairline stainless steel bronze plated decorative strip + leather pattern hard roll + hidden light strip
- Skirting line:** Bronze plated stainless steel hair pattern
- Floor:** Marble
- Recommended car door:** bronzed hairline stainless steel



U-CR227

- Front wall:** Rose gold mirror stainless steel
- Ceiling:** Rose gold mirror stainless steel frame + transparent acrylic
- Side wall:** Leather hard roll + rose gold mirror stainless steel inlaid strip + rose gold mirror stainless steel
- Rear wall:** Leather hard roll + rose gold mirror stainless steel inlaid strip + decorative luminaire
- Skirting line:** Rose gold mirror stainless steel inlaid strip + hidden light strip
- Floor:** Marble
- Recommended car door:** Rose gold mirror stainless steel



HUMAN INTERFACE



COP



COP
Model: U-CY1800
Display: 7 "TFT vertical display
Button: BR34G
Installation position: Side wall
Panel: The same as the car wall material



COP
Model: U-CY2700
Display: 7 "TFT vertical display
Button: BR36E
Installation position: Front wall
Panel: The same as the car wall material



COP
Model: U-CF3700
Display: 10.1 "TFT LCD touch display
Button: Virtual + touch button

LOP



LOP
Model: U-ZW4200
Display: 4.3 "LED segment code display
Button: Touch button
Panel: Glass panel + aluminum sandblasted frame



LOP
Model: U-ZW4100
Button: Mechanical button
Panel: Black glass + aluminum sandblasted frame



LOP
Model: TL-500
Panel: TFT LCD touch display

SIMPLE

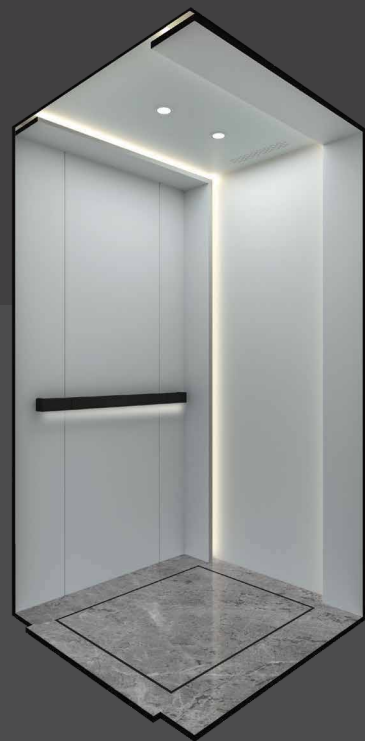

U-CR161



U-CR162



U-CR201



U-CR204

NEO-CHINESE STYLE



U-CR213



U-CR217



U-CR218



U-CR219



i520S-G PRODUCT MARKET POSITIONING

Designed with transparent car decoration, the i520S-G series sightseeing home lift provides passengers with a broader field of vision, present an excellent and efficient sightseeing experience. The safety system has been fully upgraded and adopts high-quality parametric design to meet the individual needs of different passengers.

The i520S-G series sightseeing home lift is committed to providing passengers with a safer and more comfortable riding experience.

Basic Overview

Market positioning	Villa, Townhouse etc. private
Duty Load range	premises
Speed Range	250kg-400kg
Rise	0.3-0.4m/s
Floors	15m 6/6



DECORATION



U-CR935-A (Std)

- Front Cabin:** Champagne Gold Sheet Metal Painted
- Ceiling:** White Translucent Acrylic + Black Aluminium Alloy
- Frame**
- Three Cabins(except side middle):** Champagne Gold Aluminium Alloy + Laminated Tempered Glass
- Side Middle Cabin:** Black Titanium Mirror + Strip Lights on Both Sides
- Outer Sealing Plate/Lintel:** Sheet Metal (Galvanized) Painted
- Kick Plate:** Champagne Gold Aluminium Alloy
- Floor:** Jazz White Marble



U-CR935-B

- Front Cabin:** Titanium Black Sheet Metal Painted
- Ceiling:** White Translucent Acrylic + Black Aluminium Alloy
- Frame**
- Three Cabins(except side middle):** Titanium Black Aluminium Alloy + Laminated Tempered Glass
- Side Middle Cabin:** Black Titanium Mirror + Strip Lights on both Sides
- Outer Sealing Plate/Lintel:** Sheet Metal (Galvanized) Painted
- Kick Plate:** Titanium Black Aluminium Alloy
- Floor:** Jazz White Marble

DECORATION



U-CR935-C

Front Cabin: Warm White Sheet Metal Painted
Ceiling: White Translucent Acrylic + Black Aluminium Alloy Frame
Three Cabins(except side middle): Warm White Aluminium Alloy + Laminated Tempered Glass
Side Middle Cabin: Black Titanium Mirror + Strip Lights on Both Sides
Outer Sealing Plate/Lintel: Sheet Metal (Galvanized) Painted
Kick Plate: Warm White Aluminium Alloy
Floor: Jazz White Marble



U-CR935-D

Front Cabin: Violet-blue Sheet Metal Painted
Ceiling: White Translucent Acrylic + Black Aluminium Alloy Frame
Three Cabins(except side middle): Violet-blue Aluminium Alloy + Laminated Tempered Glass
Side Middle Cabin: Black Titanium Mirror + Strip Lights on Both Sides
Outer Sealing Plate/Lintel: Sheet Metal (Galvanized) Painted
Kick Plate: Violet-blue Aluminium Alloy
Floor: Jazz White Marble

OPTIONAL CAR DECORATION



U-CR936

Front Cabin: Mirror Stainless Steel
Ceiling: Lower Hanging Painted Steel + Upper Painted Steel + Hidden Lamp (neutral light) + Spotlights
Door Sills: Outer Powder-coated steel plate (color consistent with hoistway), Inner Mirror Stainless Steel
Cabins: Mirror Stainless Steel + Mirror Stainless Steel Insert + Cloth Texture Film Plate + Laminated Tempered Glass
Handrail: Mirror Stainless Steel + Cloth Texture Steel Plate
Kick Plate: Mirror Stainless Steel
Floor: Marble



U-CR927-1

Front Cabin: Apple Sand Stainless Steel
Ceiling: Aluminium Profile Drawing Film
Cabin & Door Sills Inner: Apple Sand Stainless Steel + Laminated Tempered Glass
Outer wrapped: Color consistent with Hoistway
Floor: Marble



U-CR929-A

Front Cabin: Mirror Stainless Steel
Ceiling: Upper Painted Steel(Crescent white)+ Hidden Lamp (warm light) + Painted Steel Plate Frame(Crescent White)
Cabins: Mirror Stainless Steel + Laminated Tempered Glass
Outer wrapped: Color consistent with Hoistway
Floor: Carpet

CEILING

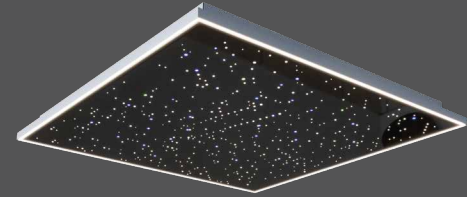

U-CL301-A Starry Sky Ceiling

*Only available for U-CR935 Series Decoration Option



LANDING DOOR



Center Opening Door(Std)



Center Opening Double Fold Door



Side Opening Door



Hand Sliding Door

Landing Door
Car
Hoistway
Optional Colors



* Above landing doors are all Aluminium Alloy Frame Glass Door

HOISTWAY OPTIONS

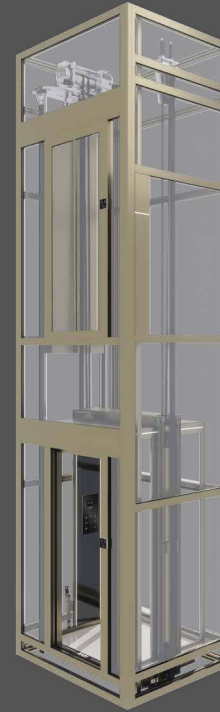

Champagne Gold



Titanium Black

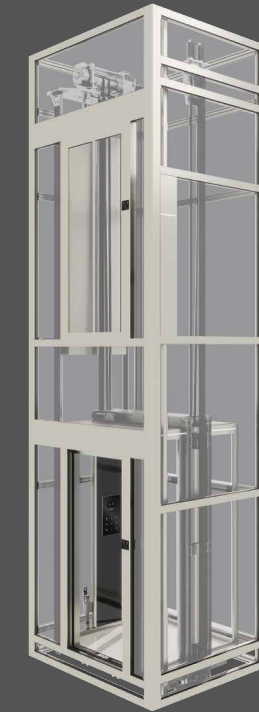

Warm White

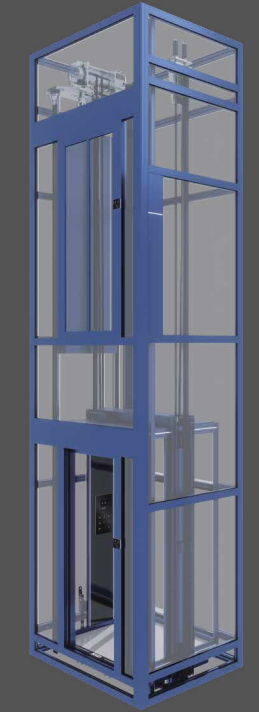

Violet-blue

STANDARD OPTIONAL CABIN

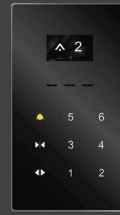

U-CF3001N-A



U-CF3001N-B

COP (Std)
 Type: U-CF3001N
 Display: 4.3' TFTL LCD
 Button: Touch Button (Mechanical Button Optional)
 Panel: Metal Frame + Glass Panel



TL-400N-A



TL-400N-B

LOP (Std)
 Type: TL-400N
 Display: LED Segment Display
 Button: Push Button
 Panel: Frosted Glass Panel



COP (Optional)
 Type: U-CY1800
 Display: 7' TFT Vertical Display - Shadows
 Button: BR34G
 Installed Position: Side Positioned
 Panel Material: Consistent with Cabin Material



COP (Optional)
 Type: U-CF2700-1
 Button: BR34G Apple Sand
 Panel Material: Apple Sand Metal



COP (Optional)
 Type: U-CF3700
 Display: 10.1' TFT LCD Touch Display
 Button: Dummy + Touch Button



TL-200-A



TL-200-D

LOP (Optional)
 Type: TL-200
 Display: LED Segment Display
 Button: Micro-button
 Panel: Glass



LOP (Optional)
 Type: TL-500
 Panel: Glass
 Display: TFT LCD Touch Display



LOP (Optional)
 Type: BR36F
 Button: Mechanical Button LOP





Landing Door Selection

Options:

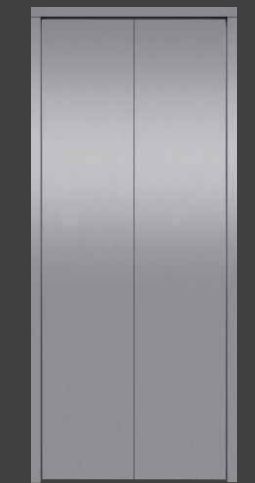

Center Opening Door
(2P-CO)



Side Opening Door
(2P-SO)



Four Panel Center Opening Door
(4P-CO)

Etching Landing Door (For Center Opening Door Only):



U-D030
Copper Hairline Etching St. Steel



U-D031
Champagne Gold Hairline Etching St. Steel



U-D033
Rose Gold Hairline Etching St. Steel



U-D034
Bronze Mirror Etching St. Steel

B PREMIUM CONFIGURATION



Controller

Installation

Standard side wall mounting, optional embedded mounting



Improve Space Utilization

Small size, easy to install

Energy saving and environmental protection

Low power consumption in standby

Enjoy the Exclusive Configuration

Equipped with contactless technology to enjoy an immersive elevator ride experience;

Energy Saving Traction Machine

High Efficiency And Energy Saving

With the low power consumption traction and the standby power consumption, which realizes the maximum energy saving.

Space Optimization

Equipped with the new rare earth permanent magnet synchronous gearless energy-saving traction, the size is 70%-80% smaller than that of the ordinary traction.



Stable Operation

The traction sheave adopts an arc-shaped section design and the surface of the spoke is coated, which make the elevator run more stably.



Steel Belt

The steel wire rope wrapped with high-tech, new wear-resistant material polyurethane layer, eliminating grease lubrication, characteristic with longer life, more environmentally friendly.

Absolute Position Control System (Standard)

Artistic

The leveling switch, reduction switch, bracket, strike bow and other components are intergrated, which makes the shaft more good looking.

Precise

The control is more precise and stable, the control accuracy reaches 0.0625mm; the speed detection accuracy reaches 0.025m/s



C COMFORT AND ENJOYMENT

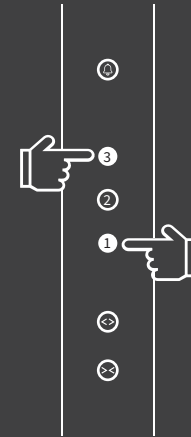

COP Self-Rescue Function (Standard)

When the elevator has a specific fault and the passengers are trapped in the car, the nearest door can be opened by the operation on the cop panel.



COP function (optional)

- VIP floor service function
- Connect to WIFI for real-time weather updates
- DIY music and wallpaper

ARD

ARD Automatic Rescue Device (Standard)

Built-in lithium battery, effectively release the cabin to the nearest floor.

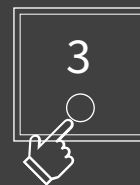

LOP function (optional)

- Child lock function
- Voice call function
- Automatic ladder locking function





Function List

Standard
 Optional

Function	Description	Note
Auto Rescue Running	When the elevator is not in maintenance mode, and did not stop on the leveling area, when meeting the safety requirements, the elevator will automatically run at slow to a leveling area, and then open the door.	●
Emergency Rescue Running	When manual winding required over 400N, set up the emergency electric operation switch and operation, to replace manual winding	●
One-click distress function	Call the intercom host on the COP through the talk button. When there is no answer, the intercom host will automatically dial the 3 phone numbers (or mobile phones) set in turn until it is connected.	●
ARD Automatic rescue function	When the running car is not in the door area and the person is trapped due to the power failure of the building, the power failure emergency leveling device will start, driving the elevator to run to the door area at a low speed to open the door and release the person.	●
In-Car Autonomous Rescue Function	When the passenger is trapped in the cabin, if the elevator fault is a recoverable fault and does not affect the safe operation of the elevator, the passenger can press the top and bottom buttons at the same time and hold it for more than 10 seconds. In this way, the elevator can temporarily shield the fault and run to the leveling position automatically, open the door to release people, and lock the elevator.	●
Child Safety Lock	The HOP has the function of password setting and elevator locking to prevent children from operating the elevator and avoid the possible danger.	○
Absolute Position System	The control cabinet can be configured with an absolute position system, which can greatly reduce the hoistway components and optimize the hoistway space	●
VIP floor service function	After setting a password for a specified floor, if you want to register for that floor, you need to enter the password before you can register successfully	○

More functions please contact our sales.



Civil engineering layout

i520 Pro Layout - Side Opening (CWT at rear)

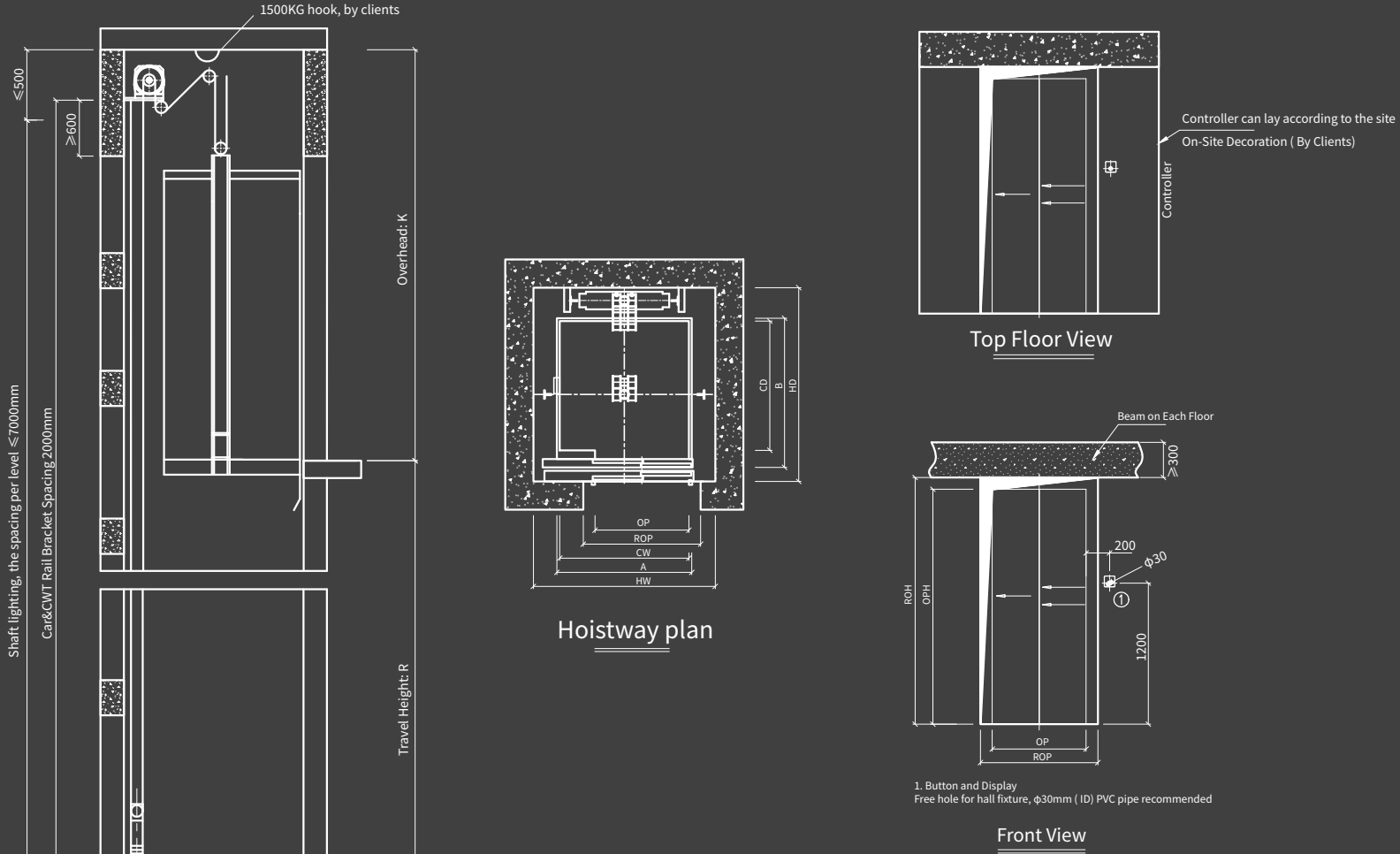

	L	DS	CP	HW	HD	CW	CD	OP	CRH	K	S
i520 Pro II	250	Side Opening Door (2P-SO)	CWT at rear	1300	1500	950	950	650	2200	3000	250
	320			1350	1600	1000	1050	700			
	400			1450	1650	1100	1100	800			

i520 Pro Layout - Center Opening (CWT at rear)

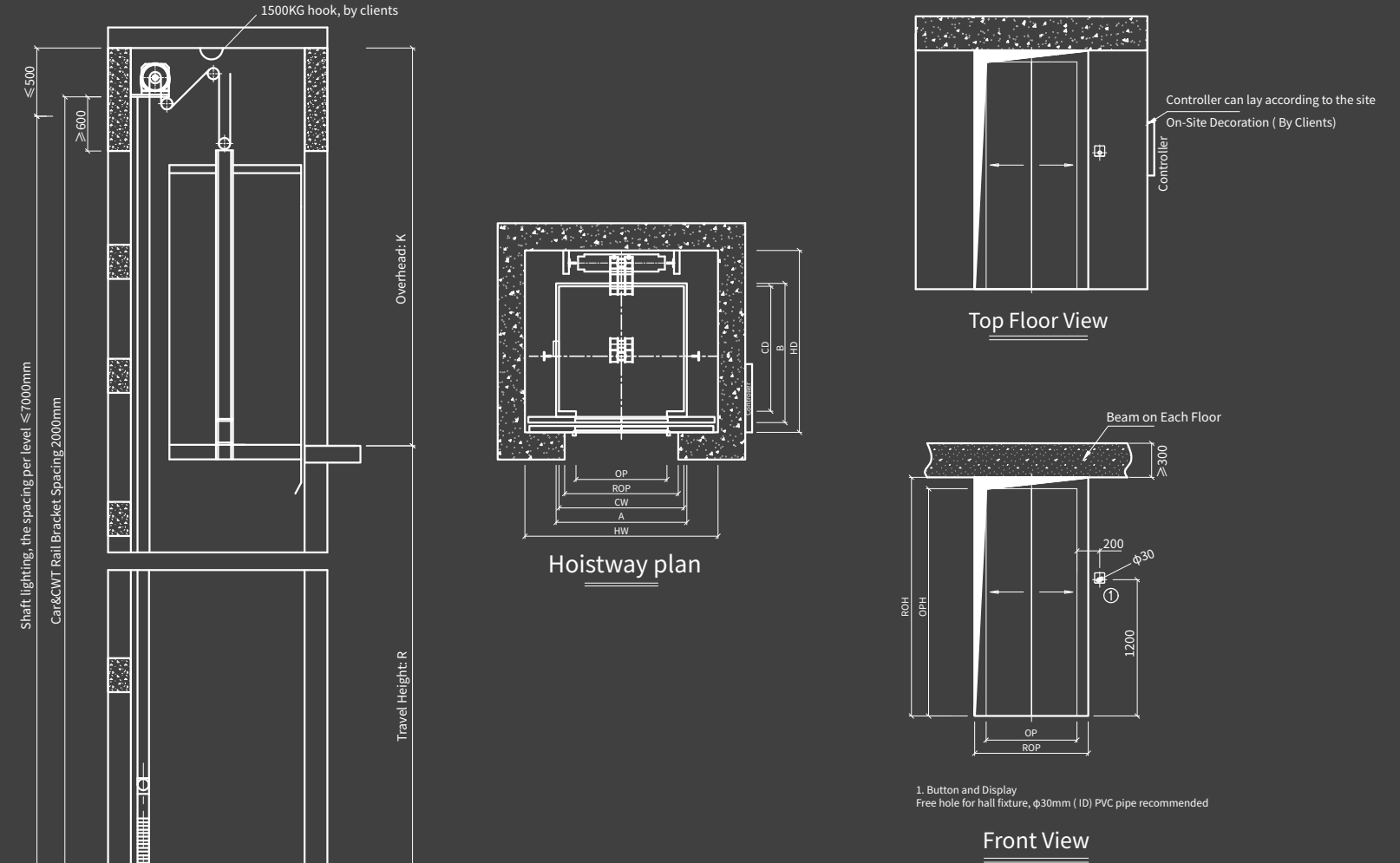

	L	DS	CP	HW	HD	CW	CD	OP	CRH	K	S
i520 Pro II	250	Center Opening Door (2P-CO)	CWT at rear	1300	1450	950	950	600	2200	3000	250
	320			1350	1550	1000	1050	600			
	400			1450	1600	1100	1100	650			

Civil engineering layout

i520 Pro Layout - Center Opening (CWT at side)

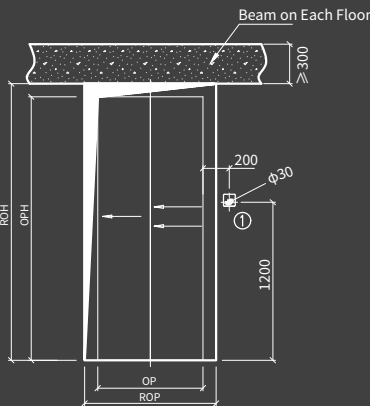
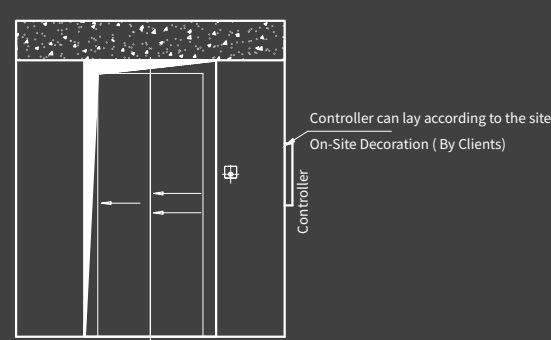
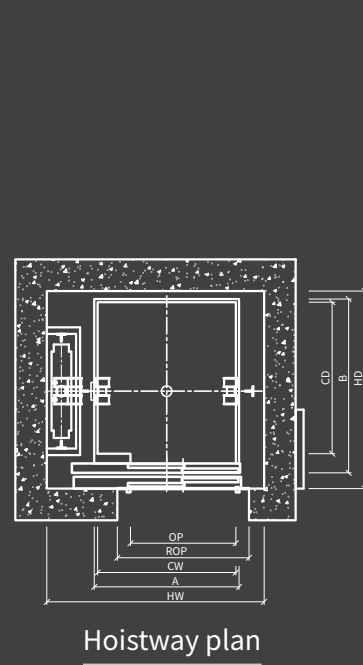
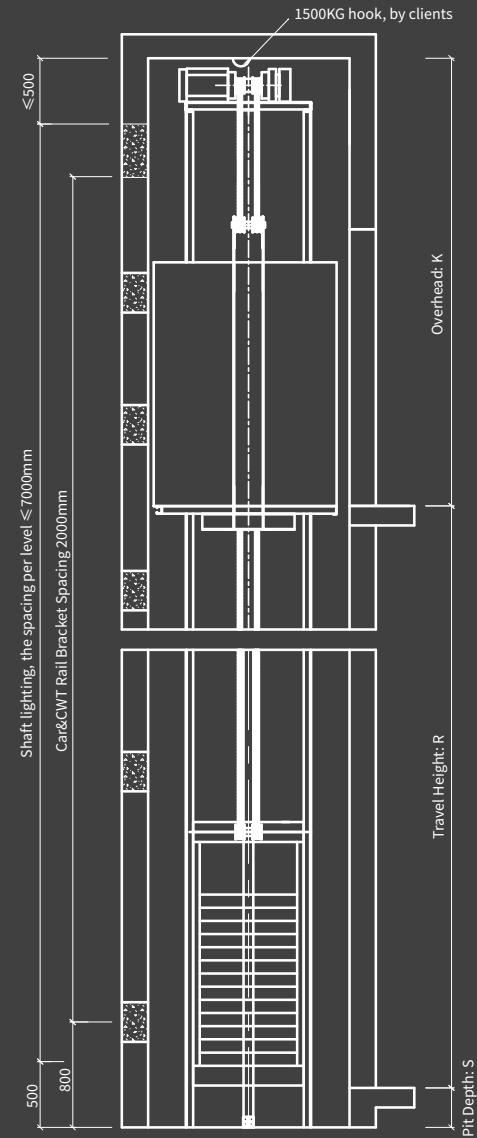

	L	DS	CP	HW	HD	CW	CD	OP	CRH	K	S
i520 Pro II	250	Side Opening Door (2P-S0)	CWT at side	1400	1350	900	1000	650	2200	2850	250
	320			1500	1400	1000	1050	800			
	400			1600	1450	1100	1100	800			

i520 Pro Layout - Center Opening (CWT at side)

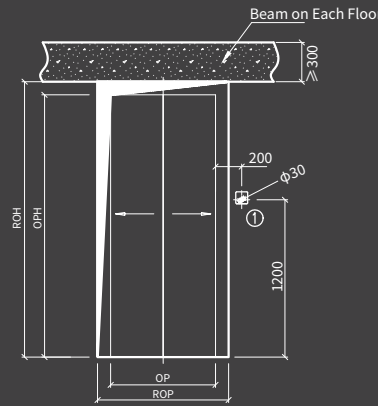
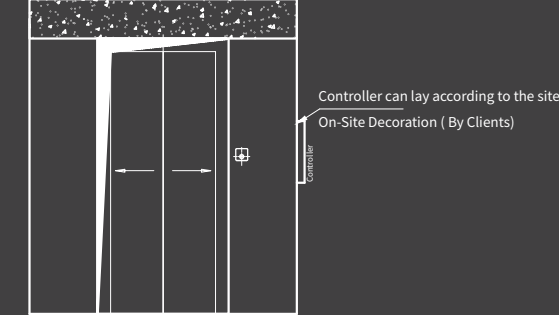
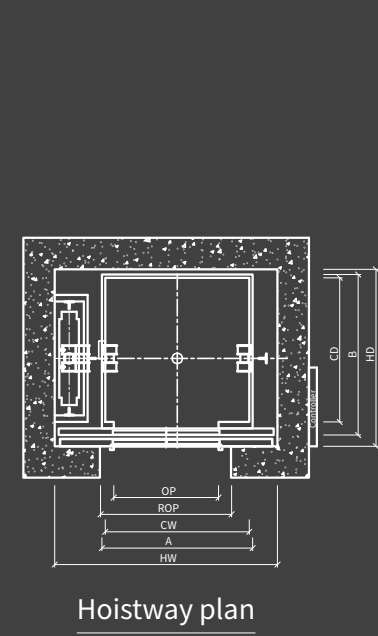
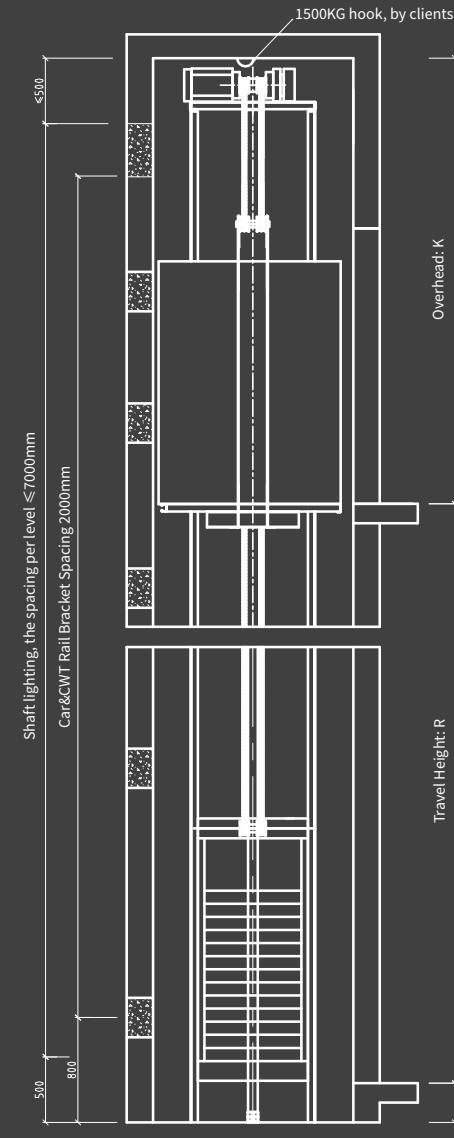

	L	DS	CP	HW	HD	CW	CD	OP	CRH	K	S
i520 Pro II	250	Center Opening Door (2P-C0)	CWT at side	1400	1250	900	1000	650	2200	2850	250
	320			1500	1300	1000	1050	700			
	400			1600	1350	1100	1100	750			

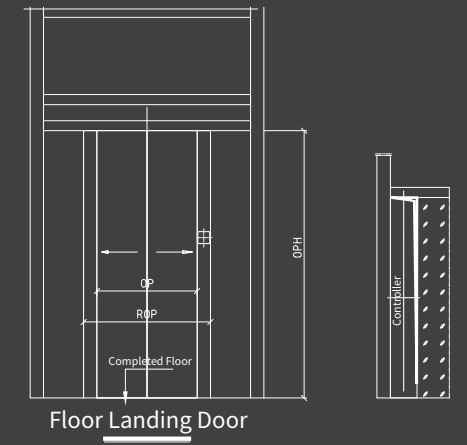
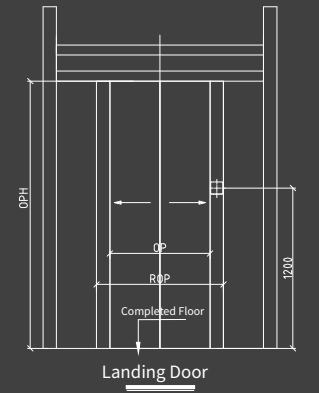
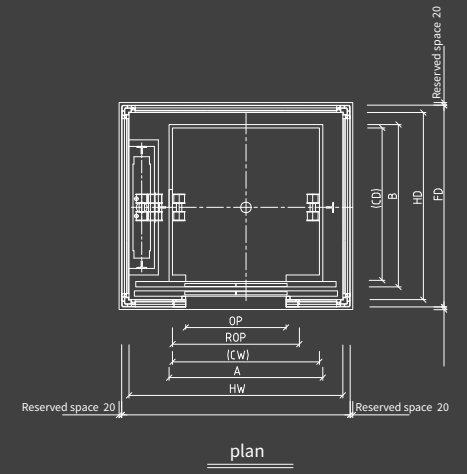
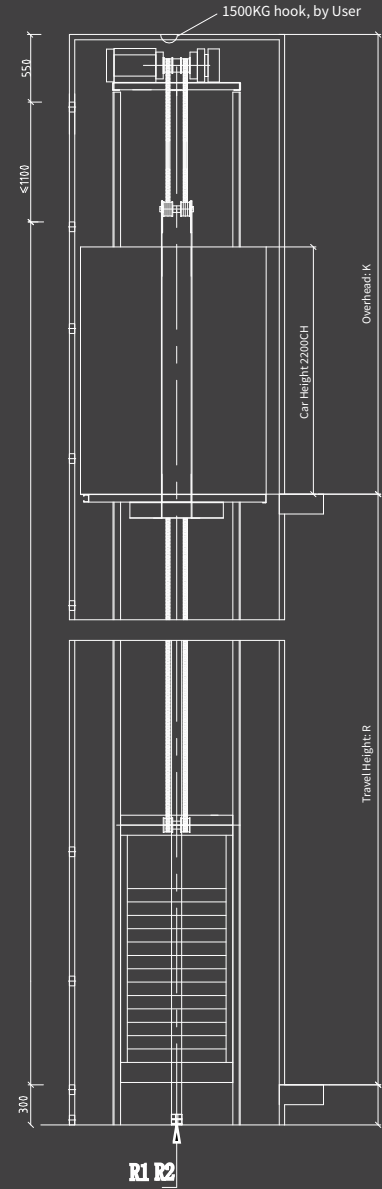

i520S-G Side Opening Door with Counterweight Side Located

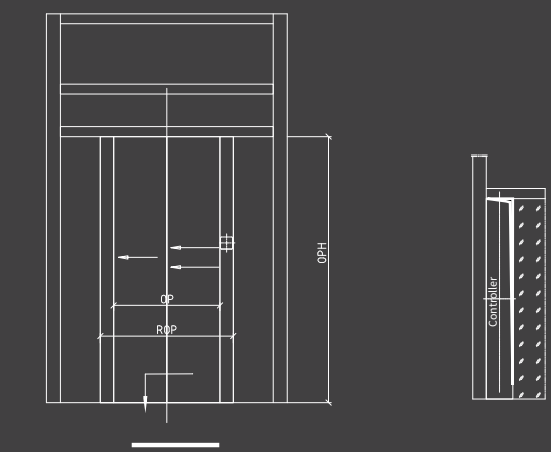
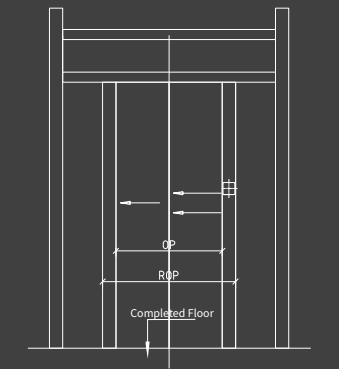
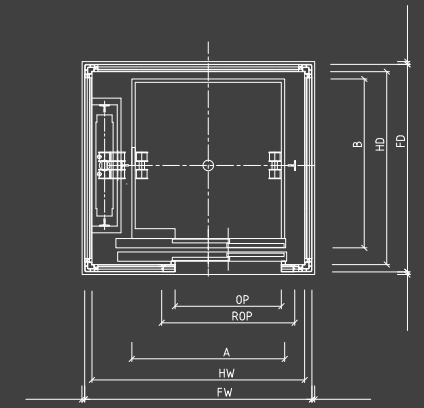
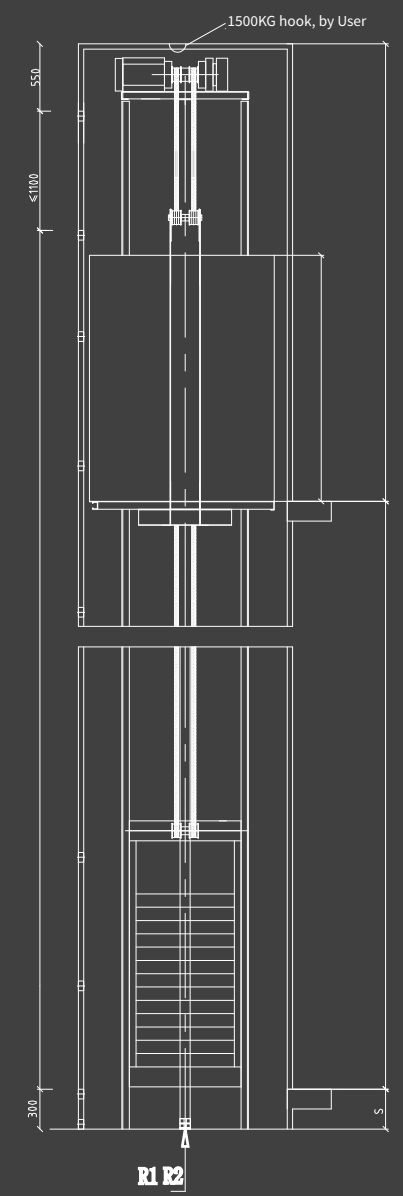

Civil engineering layout

i520S-G 4-P Center Opening Door with Counterweight Side Located

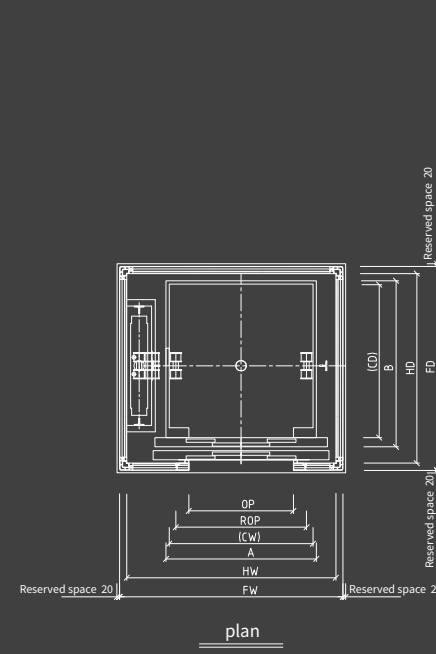
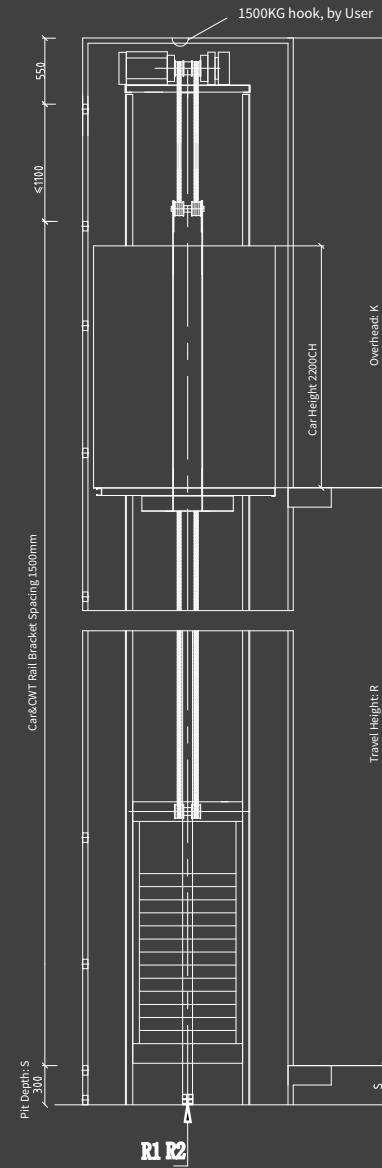

Side

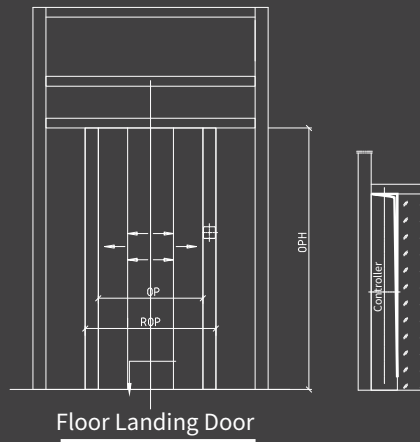
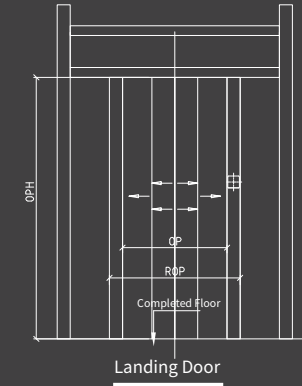

L	Speed (m/s)	Car Outer Size Width x Depth (mm)	Car Net Size Width x Depth (mm)	Opening Net Size Width x Height (mm)	Hoistway Net Size Width x Depth (mm)	Car Height (mm)	Pit Depth (mm)	Overhead Height (mm)
400	0.4	1150×1270	1100×1100	800×2000	1600×1450	2200	300	3000
320		1050×1220	1000×1050	700×2000	1500×1400			
250		950×1170	900×1000	650×2000	1400×1350			

i520S-G Hand Sliding Door with Counterweight Side Located

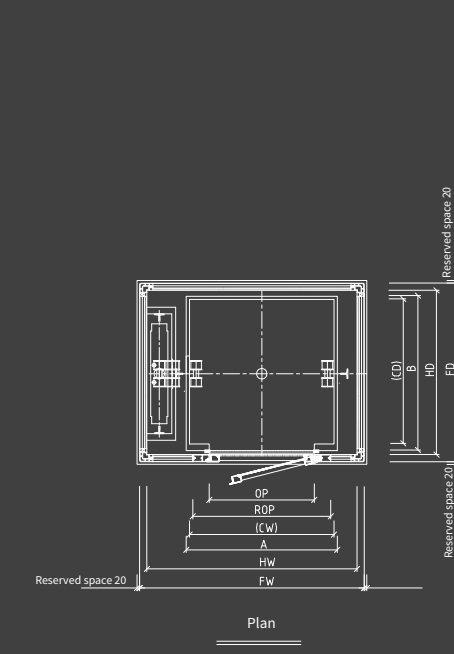
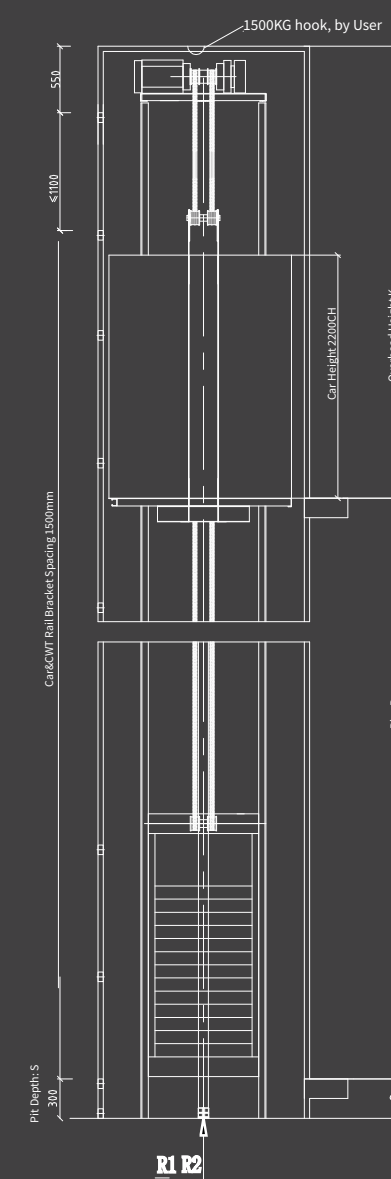

Plan

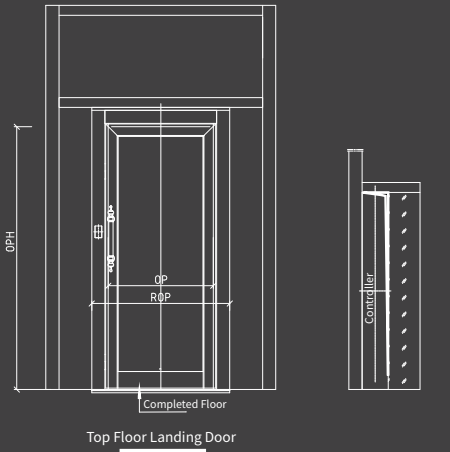
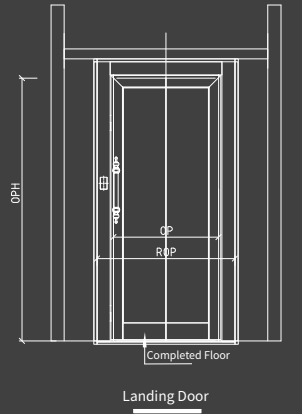

L	Speed (m/s)	Car Outer Size Width x Depth (mm)	Car Net Size Width x Depth (mm)	Opening Net Size Width x Height (mm)	Hoistway Net Size Width x Depth (mm)	Car Height (mm)	Pit Depth (mm)	Overhead Height (mm)
400	0.3	1150×1175	1100×1100	800×2000	1600×1250	2200	300	3000
320		1050×1125	1000×1050	750×2000	1500×1200			
250		950×1075	900×1000	650×2000	1400×1150			

Civil engineering layout

i520S-G Center Opening Door with Counterweight Rear Located

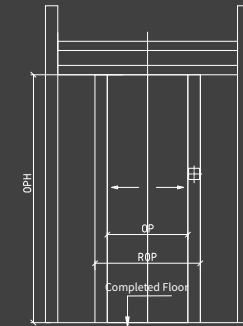
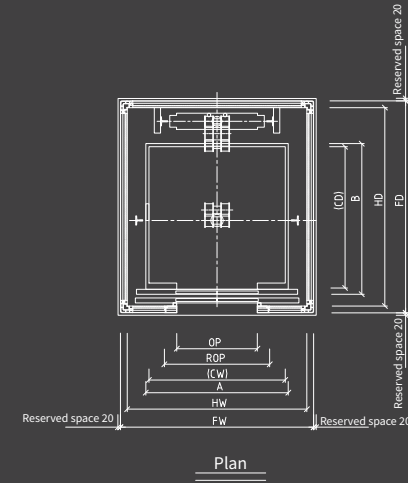
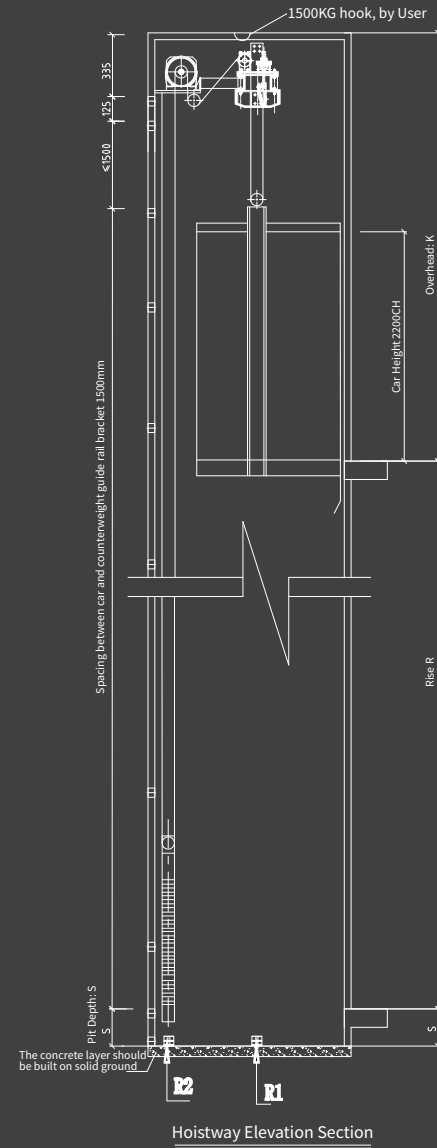

Landing Door

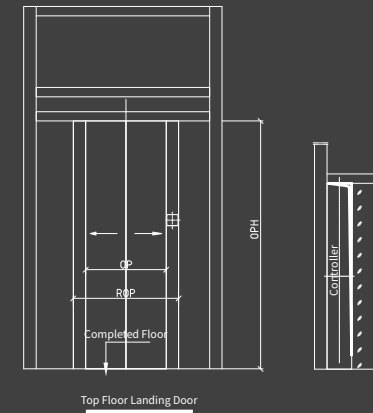

Top Floor Landing Door



i520S-G Side Opening Door with Counterweight Rear Located

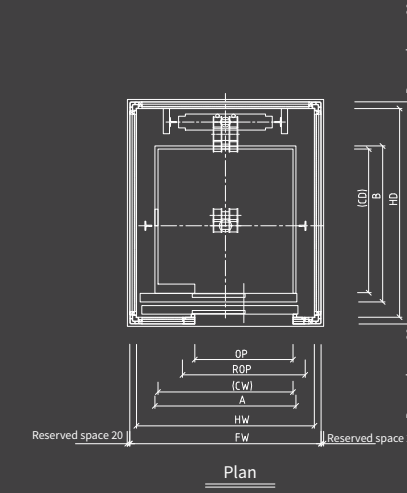
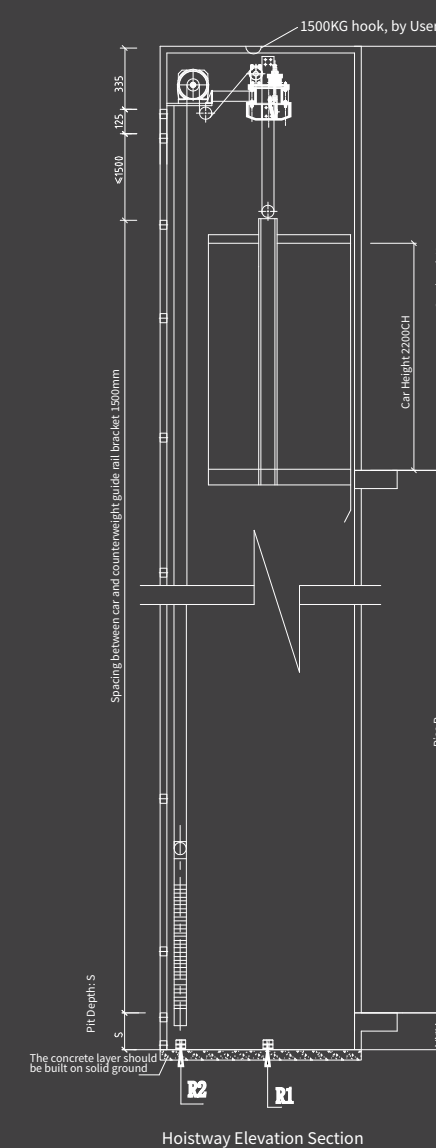

Plan

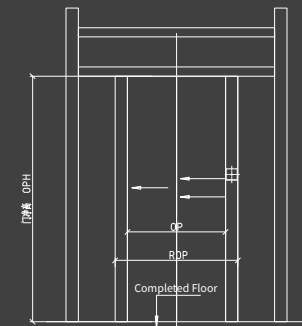

Landing Door

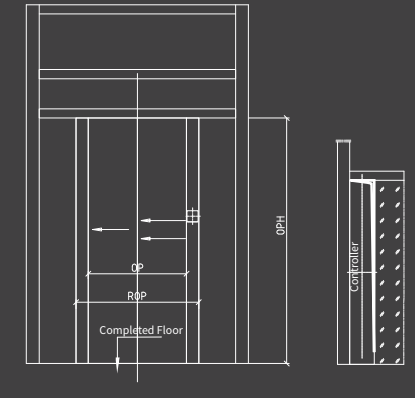

Top Floor Landing Door

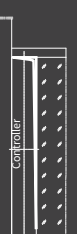

Civil engineering layout

i520S-G 4-P Center Opening Door with Counterweight Rear Located

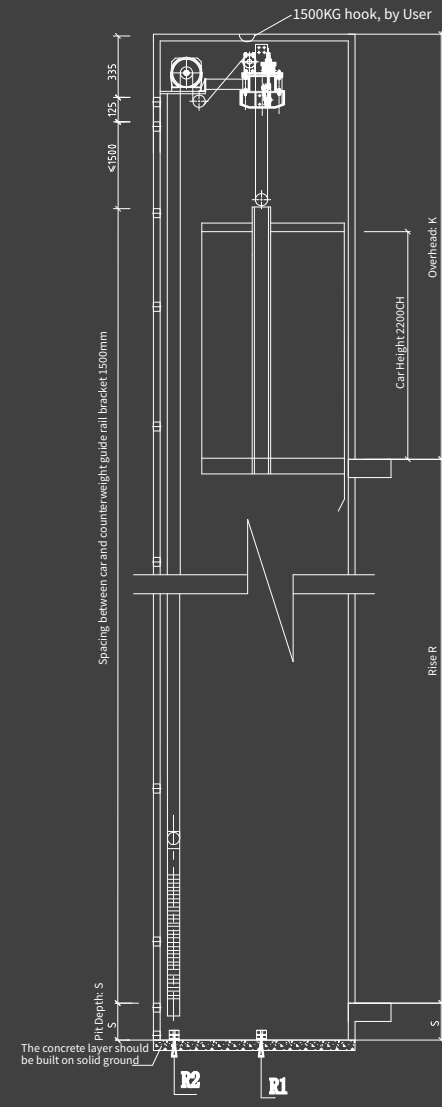

Hoistway Elevation Section

L	Speed (m/s)	Car Outer Size Width x Depth (mm)	Car Net Size Width x Depth (mm)	Opening Net Size Width x Height (mm)	Hoistway Net Size Width x Depth (mm)	Car Height (mm)	Pit Depth (mm)	Overhead Height (mm)
400	0.4	1150×1270	1100×1100	800×2000	1450×1700	2200	300	3200
320		1050×1220	1000×1050	700×2000	1350×1650			
250		1000×1170	900×1000	650×2000	1300×1600			

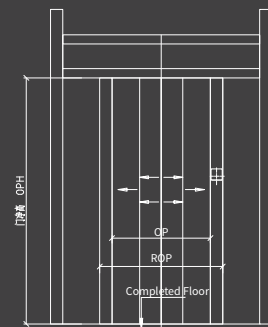
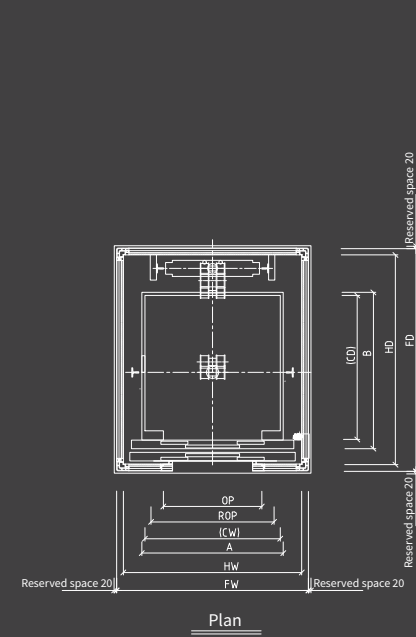

Landing Door

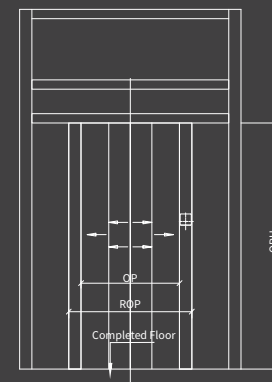

Top Floor Landing Door

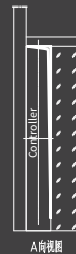

A向视图

i520S-G Hand Sliding Door with Counterweight Rear Located

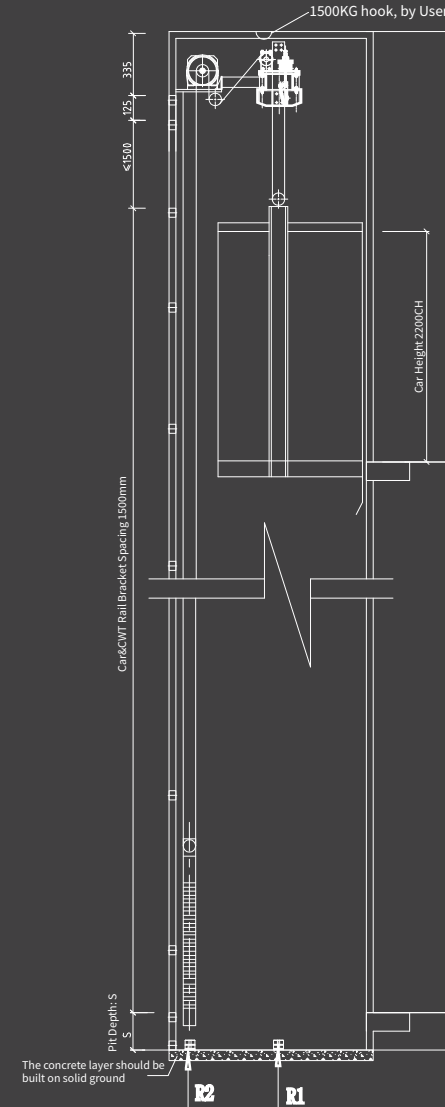

Hoistway Elevation Section

L	Speed (m/s)	Car Outer Size Width x Depth (mm)	Car Net Size Width x Depth (mm)	Opening Net Size Width x Height (mm)	Hoistway Net Size Width x Depth (mm)	Car Height (mm)	Pit Depth (mm)	Overhead Height (mm)
400	0.3	1150×1175	1100×1100	800×2000	1450×1500	2200	300	3200
320		1050×1225	1000×1050	800×2000	1350×1450			
250		1000×1075	900×1000	750×2000	1300×1400			

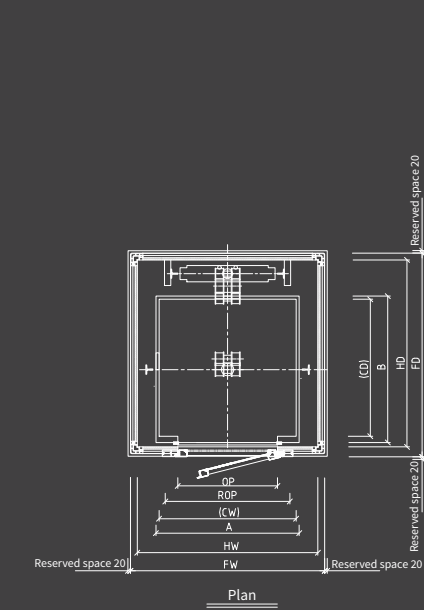

Plan

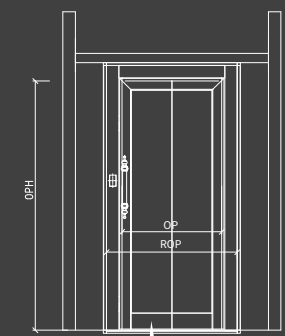

Landing Door

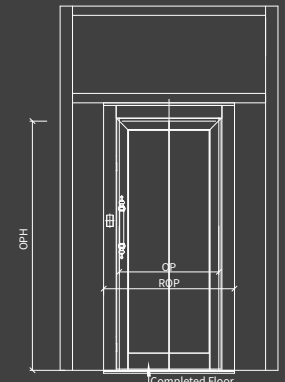

Top Floor Landing Door

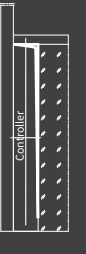

A向视图